



DL

 DECORATIVE
LABELING

EZ-STANDARD LOW TO MID-SPEED SHRINK SLEEVE AND TAMPER EVIDENT APPLICATORS



Flexible and economical shrink sleeve and tamper band application at speeds up to 150 cpm for single head models and up to 300 cpm for dual head models

EZ-Standard applicators are the low to mid-speed, value priced models in Axon's complete line of shrink sleeve and tamper band systems. EZ-Standard includes a series of four models that accommodate film widths up to 300 mm (11.8").

EZ-Standard models are offered with single-head and dual head configurations and dual head configurations are capable of steady-state production speeds up to 300 cpm. EZ-Standard applicators are vacuum style machines that deliver fast, tool-less five-minute size changeovers and consistent, repeatable performance.

FEATURES AND BENEFITS

- **Fully automatic** - Application process is fully automated, recipe driven and a touch screen HMI makes operation simple
- **Size range flexibility** - Container diameters or multipack cross-sections range from 0.8" (20 mm) to 7.3" (187 mm). Larger sizes are compatible with EZ-Wide applicators
- **Simple to operate, easy to maintain** - Machine design minimizes use of moving parts which reduces complexity for both operators and maintenance personnel
- **Fast, tool-less size changeovers** - Size changeovers can be completed in five minutes or less
- **Guillotine style cutter** - Simple, durable and dependable two-blade cutting system delivers consistent, clean cuts
- **Long blade life** - Under normal operating conditions EZ-Standard cutting blades can be used for up to one year before replacement is required
- **Modular head design** - Single head applicator can be easily upgraded to a dual heads for increased production speeds
- **Vacuum spreader guide system** - Simple vacuum technology with inexpensive film spreader guides makes change parts inexpensive, and a true bargain

SHRINK APPLICATIONS

Like every Axon shrink sleeve applicator, EZ-Standard offers the flexibility to perform multiple shrink applications. This flexibility makes Axon shrink sleeve applicators one of the best values in the industry.



FULL BODY

 FULL BODY
OVER THE CAP

TAMPER EVIDENT



TAMPER EVIDENT



PARTIAL



MULTIPACK



EZ-STANDARD LOW TO MID-SPEED SHRINK SLEEVE AND TAMPER EVIDENT APPLICATORS

TYPICAL PRODUCT SPECIFICATIONS

	EZ-100	EZ-130	EZ-200	EZ-300
Max. Rate (1 Head)	150 cpm*	150 cpm*	120 cpm*	70 cpm*
Max. Rate (2 Head)	300 cpm*	300 cpm*	240 cpm*	130 cpm*
Sleeve Lay Flat Range	20 mm - 112 mm (.79" - 4.41")	20 mm - 130 mm (.79" - 5.12")	55 mm - 205 mm (2.17" - 8.07")	80 mm - 300 mm (3.15" - 11.81")
Product Diameter	11 mm - 68 mm (.43" - 2.68")	11 mm - 80mm (.43" - 3.15")	35 mm - 124 mm (1.38" - 4.88")	50 mm - 187 mm (1.97" - 7.36")
Applied Materials	PVC, PETG, OPS, PLA			
Film Thickness	40-70 microns (1.5-3.0 mil)			50-70 microns (2.0-3.0 mil)
Controls	Siemens - Standard Allen-Bradley PLC - Optional			
Power	220 VAC, 1-Phase			
Air	80 psi			
Air Volume	3-5 cfm			5 cfm

* Dependent on product size and shape

CONFIGURATION

Top view

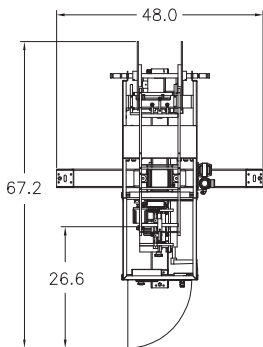

Front view

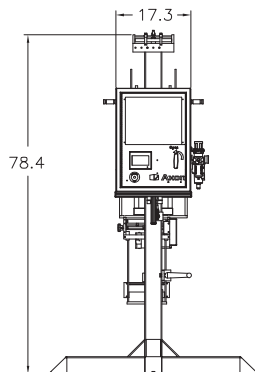

Dimensions are in inches

OPTIONS

- **Static Reduction** - Mitigates static build-up and increases uptime
- **Print Registration** - Fiber optic sensor reads film registration marks so the PLC can calculate cut lengths to assure sleeve length accuracy
- **Vertical, Horizontal & T Perforators** - Add perforations to enhance ease of opening
- **Band Positioning** - Belt system assures correct placement of tamper bands or partial body sleeves during application process
- **Low Film Alarm** - Automatically detects low film levels and alerts operator
- **Product Spacers** - Precisely separate containers at the infeed to assure smooth production
- **Infeed Timing Screws** - Required for multipacks, certain container geometries
- **Spare Parts Kit** - Recommended start-up parts inventory

SHRINK APPLICATIONS



FULL BODY



FULL BODY
OVER THE CAP



TAMPER EVIDENT



TAMPER EVIDENT



PARTIAL



MULTIPACK

©2025 ProMach Inc. ProMach reserves the right to change or discontinue specifications and designs shown in this brochure without notice or recourse
PM-AX-SP103_Axon_EZ-Standard_0719v2

PHONE
919-772-8383

EMAIL
Axon@ProMachBuilt.com

WEB
AxonCorp.com

Axon LLC
3080 Business Park Dr, Suite 103
Raleigh, NC 27610